



# Installation Instructions

**Thank you for purchasing this anti-sway bar kit. Please read through these instructions before installation.**

## Front Anti-Sway Bar Kit for the Monaco Diplomat

part #1169-208

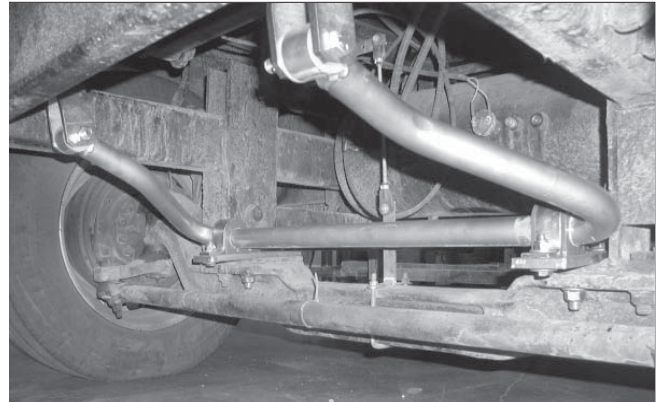

## INTRODUCTION

Thank you for purchasing this anti-sway bar kit. This kit is designed to improve the handling characteristics of your motorhome by reducing the body roll and balancing the weight transfer during cornering. The anti-sway bar kit is engineered for long life and trouble-free performance. For maximum suspension control, use this kit along with our rear anti-sway bar kit.

All the hardware needed for installation is included in this kit. Refer to the PARTS LIST in these instructions to identify the parts.

## SUGGESTED TOOLS

The following tools are suggested to complete the installation procedures:

- General hand tools
- Torque wrench

### **Free Lifetime Warranty**

*You must accurately and completely fill out and mail the product registration card within thirty (30) days from the date of purchase to qualify for your warranty.*

*Your product registration is an important record for Source Engineering, Inc. to keep in touch with you. It also enables us to expedite any future claim, update or recall that may arise concerning our products.*

# PARTS LIST

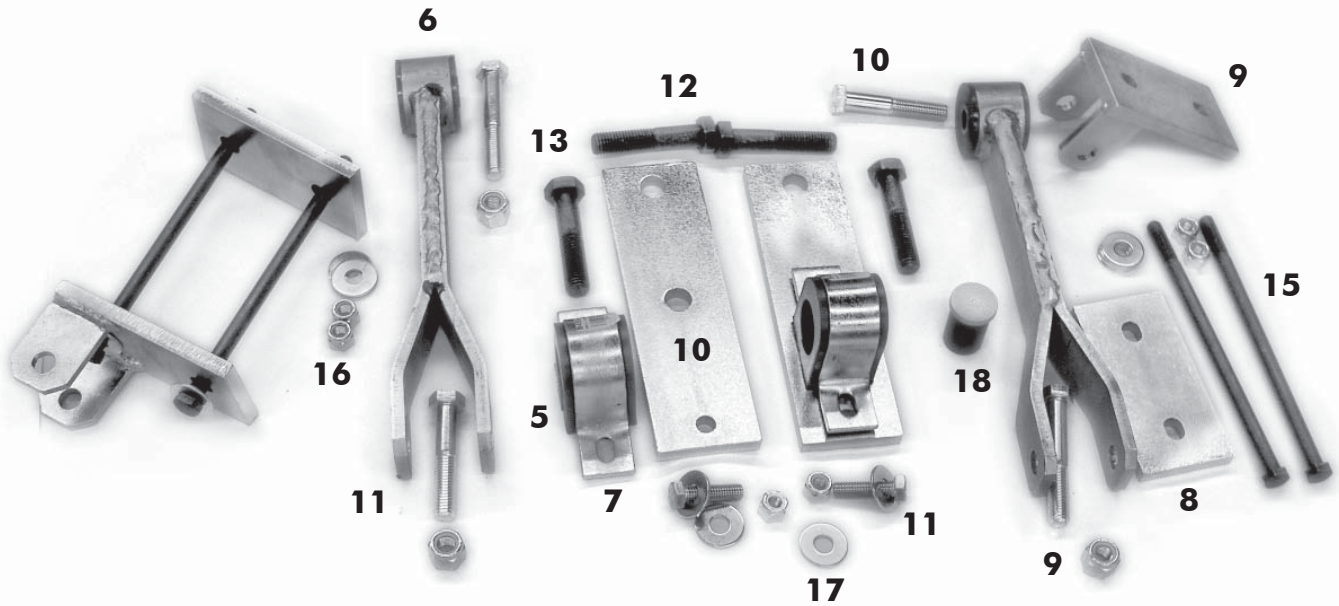

Part #1169-208

Part #	Description	Qty		Part #	Description	Qty
1.	580082-00 Front sway bar, 1-5/8"	1	*	10.	B462 Bracket, 10-1/4 x3"x1/2"	2
2.	205209-00 Poly bushing	4	*	11.	350096-80 Bolt NC, 1/2" x 1-3/4"	2
3.	205503-00 Sleeve	4		12.	350163-00 Bolt, 5/8" x 3-1/2"	2
4.	205202-10 Poly bushing	4		13.	350158-00 Bolt, 5/8" x 4"	2
5.	205222-10 Poly bushing, 1-5/8" split	2		14.	350274-80 Bolt, 3/4" x 3-1/2"	4
6.	B404 Shackle, 12-5/8"	2		15.	357461-00 Bolt, 1/2" x 9-1/2"	4
7.	B459 U-clamp bracket	2		16.	350259-00 Nyloc nut, 1/2"	6
8.	B460 Bracket, 6"x3"x1/2"	2		17.	350308-00 Washer, 1/2"	12
9.	B461 Bracket with tabs	2		18.	400011-30 AQUALUBE Grease	1
10.	350263-00 Nyloc Nut 5/8"	4				

\* not shown

# INSTALLATION

The following instructions must be followed in the order listed to ensure a proper installation and to preserve the Source Engineering, Inc. warranty.

## 1. Install the axle brackets.

Begin by removing the two inside axle bolts that attach the H frame to the axle on each side. Now, install the B462 bracket using the longer bolts provided in the kit. (Figure 1)

*Note:* only install the front bolt at this time. Do not tighten. The tab of the bracket goes toward the rear of the chassis.

## 2. Prepare the anti-sway bar for installation.

Locate the D-shaped anti-sway bar bushings. Lubricate the inside with the supplied grease. Install the bushings onto the anti-sway bar. Now, slip the B459 bushing clamp onto the bushings. (Figure 2)

*Note:* the large hole in the bracket goes toward the front of the chassis. Tighten the axle bracket bolts and the anti-sway bar bushing clamp bolts.

## 3. Install the shackle frame brackets.

Locate the frame cross member above the back of the H-frame. See Figure 3. The B460 flat plate sits on top of the cross member and is connected to the B461 shackle bracket by the long bolts. The tabs on the bracket face down and towards the front of the chassis. Loosely assemble and slide the brackets as far outboard as possible, then tighten.

## 4. Attach the shackles to the frame brackets.

Using the provided hardware F351 bolts (3-1/2" long) hang the shackles from the frame brackets. (Figure 4)

## 5. Attach the sway bar to shackle.

Using the provided hardware F352 bolts (4" long) connect the shackles to the anti-sway bar. (Figure 4)

## 6. Recheck all the fasteners and then test drive.

## 7. Recheck all the fasteners after test driving.

Listen for any unusual noises.

## WARNING

After road testing, re-check all fasteners for proper tightness — if a fastener has worked loose or fallen off, re-tighten or replace it. Without all kit components properly tightened or in place, the anti-sway bar will not stabilize the vehicle at full capacity, which may cause reduced cornering ability or other reductions in vehicle handling or performance.

Failure to follow these instructions may result in property damage, personal injury or even death.

## WARNING

### **The anti-sway bar is not a load-bearing component**

Do not tow or hoist the vehicle using the anti-sway bar or its mounting brackets as attachment points. The anti-sway bar is not designed to carry the weight of the vehicle and may collapse, which will damage the anti-sway bar components, the suspension, or other components. The vehicle will detach or fall, which may cause severe personal injury.

Failure to follow these instructions may result in property damage, personal injury or even death.

# INSTALLATION

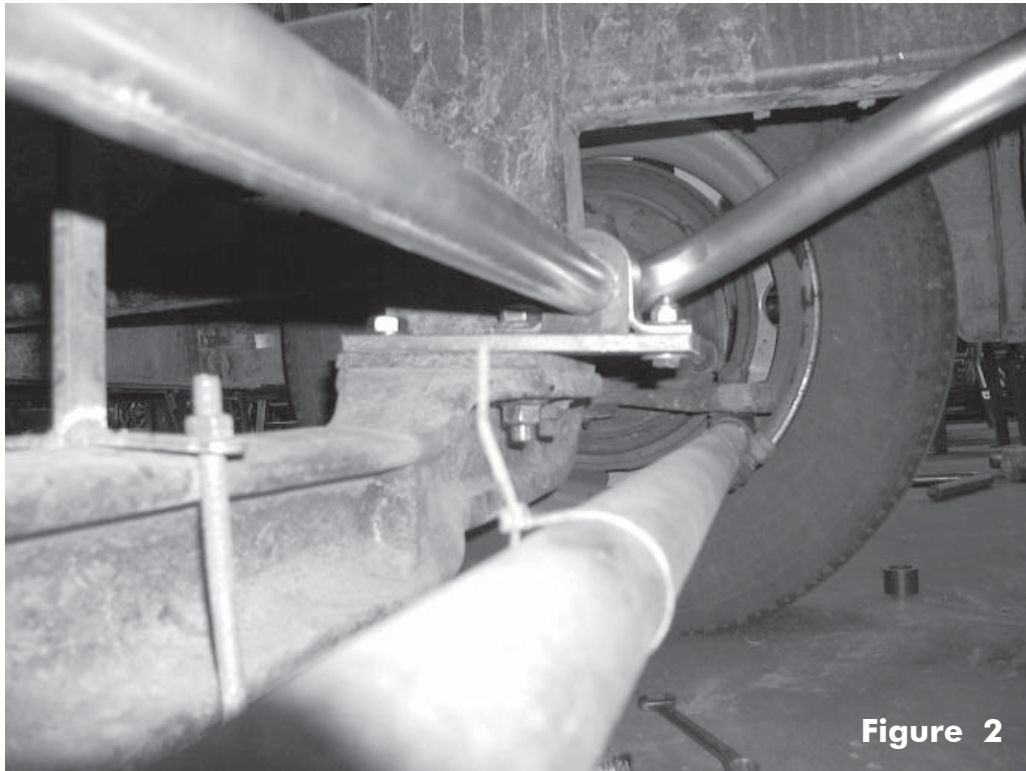
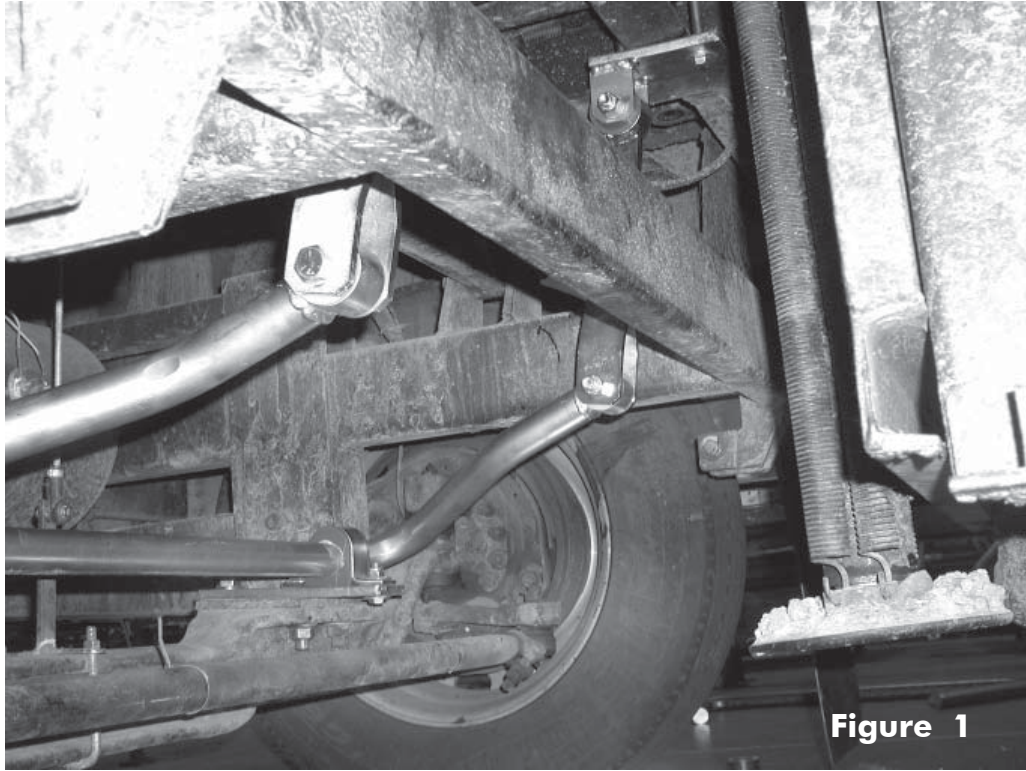

Rear of Coach →

# INSTALLATION

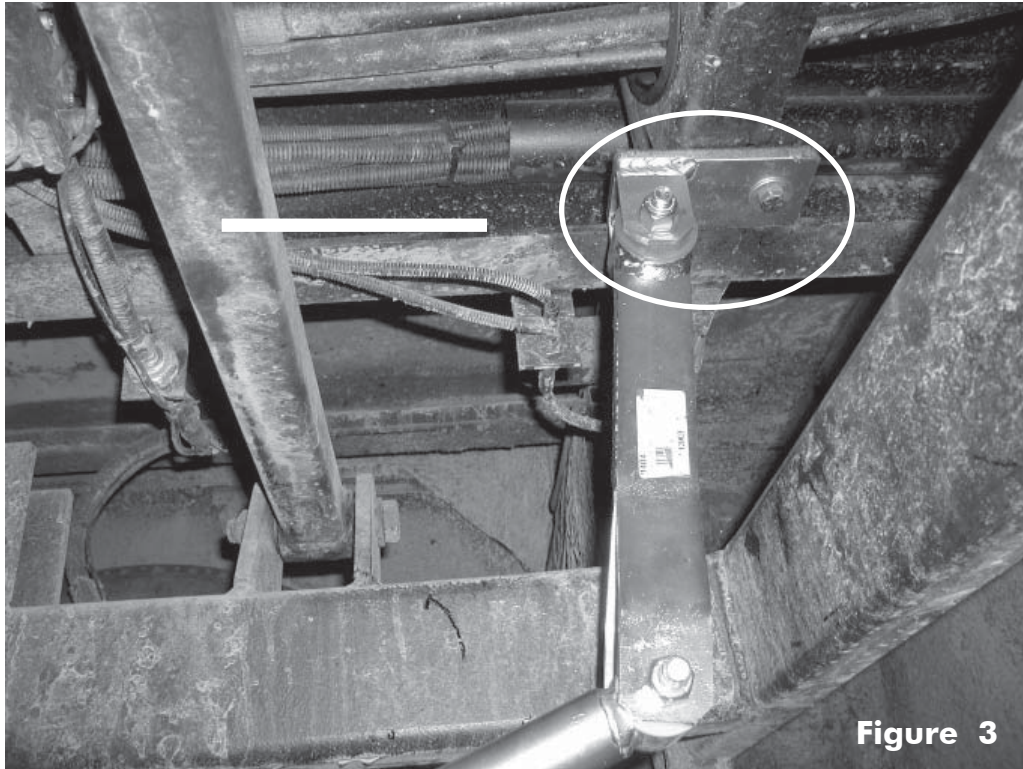

Figure 3

← Front of Coach

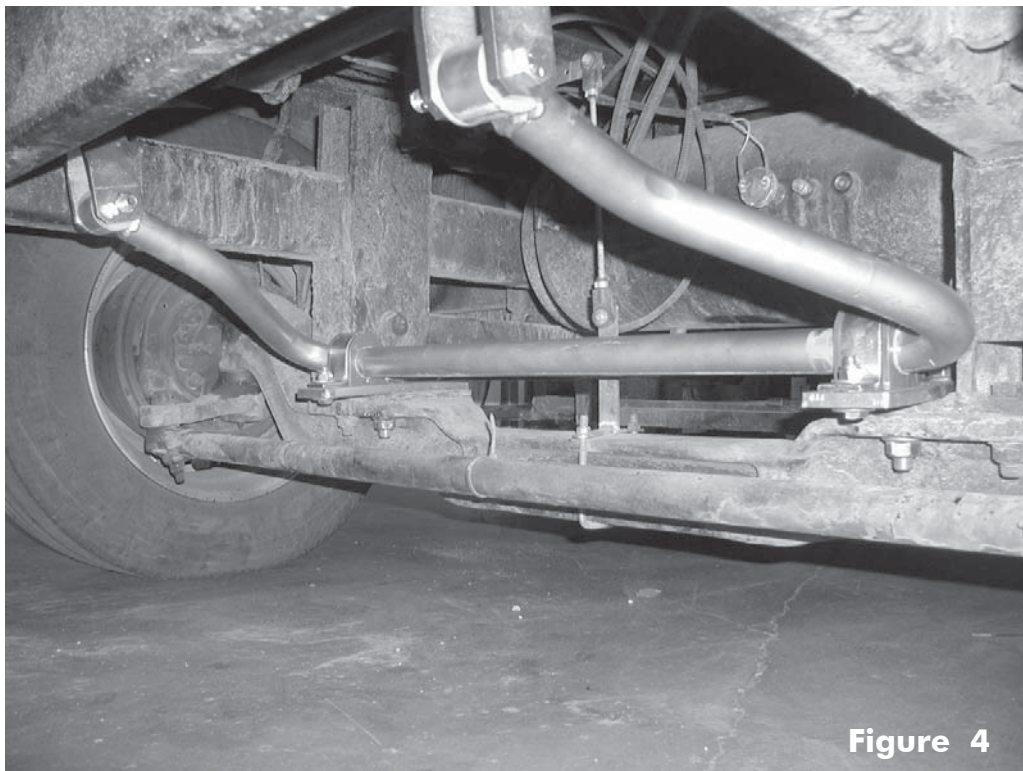

Figure 4

Front of Coach →